

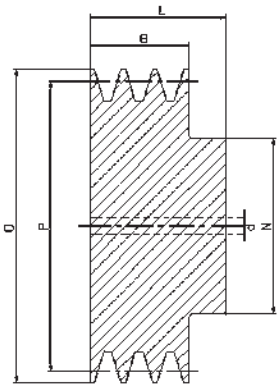

PULEGGE TRAPEZOIDALI MONOBLOCCO

V-Belt pulleys with solid hub
Keilriemenscheiben ungebohrt
Poulies trapézoidales moyeu plein
Poleas trapezoidales con cubo macizo



1

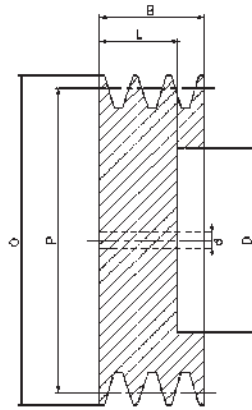

2

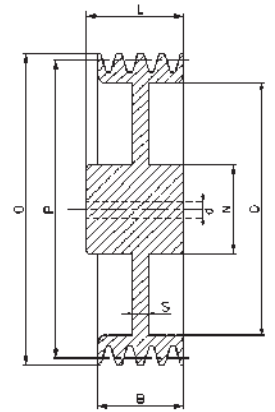

3

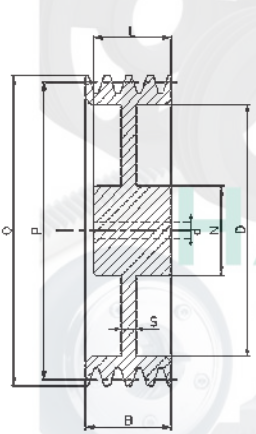

4

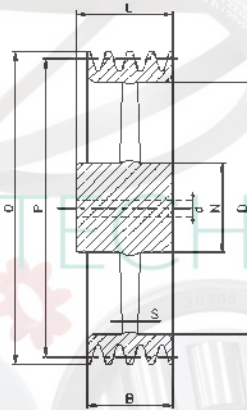

5

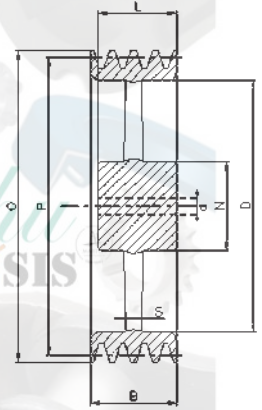

6

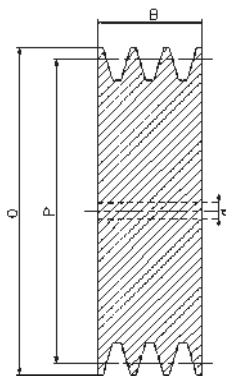

7

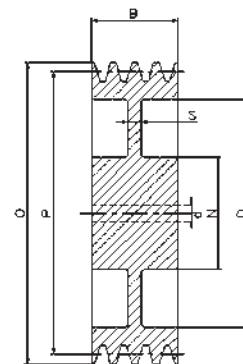

8

| Cod. interno Internal code Code interne Código interno | Descrizione Description Beschreibung Description Descripción | P | O | Gole Grooves Rillen Gorges Canales | N | L | D | S | B | Forma Form Forme Forme Forma | d | Peso Weight Gewicht Poids Peso |
|---|--|------------|-----|--|----|----|-----|---|----|--|----|--|
| ZM00501 | SPZ50 | 50 | 54 | 1 | 40 | 28 | | | 16 | 1 | 10 | |
| ZM00502 | | | | 2 | 40 | 35 | | | 28 | 1 | 10 | |
| ZM00503 | | | | 3 | | | | | 40 | 7 | 10 | |
| ZM00561 | SPZ56 | 56 | 60 | 1 | 45 | 28 | | | 16 | 1 | 10 | |
| ZM00562 | | | | 2 | 45 | 35 | | | 28 | 1 | 10 | |
| ZM00563 | | | | 3 | | | | | 40 | 7 | 10 | |
| ZM00631 | SPZ63 | 63 | 67 | 1 | 50 | 28 | | | 16 | 1 | 10 | |
| ZM00632 | | | | 2 | 50 | 35 | | | 28 | 1 | 10 | |
| ZM00633 | | | | 3 | | | | | 40 | 7 | 10 | |
| ZM00711 | SPZ71 | 71 | 75 | 1 | 50 | 28 | | | 16 | 1 | 10 | |
| ZM00712 | | | | 2 | 55 | 35 | | | 28 | 1 | 10 | |
| ZM00713 | | | | 3 | | | | | 40 | 7 | 10 | |
| ZM00751 | SPZ75 | 75 | 79 | 1 | 50 | 28 | | | 16 | 1 | 10 | |
| ZM00752 | | | | 2 | 60 | 35 | | | 28 | 1 | 10 | |
| ZM00753 | | | | 3 | | | | | 40 | 7 | 10 | |
| ZM00801 | SPZ80 | 80 | 84 | 1 | 50 | 28 | | | 16 | 1 | 10 | |
| ZM00802 | | | | 2 | 60 | 35 | | | 28 | 1 | 10 | |
| ZM00803 | | | | 3 | | | | | 40 | 7 | 10 | |
| ZM00851 | SPZ85 | 85 | 89 | 1 | 50 | 28 | | | 16 | 1 | 10 | |
| ZM00852 | | | | 2 | 60 | 35 | | | 28 | 1 | 10 | |
| ZM00853 | | | | 3 | | | | | 40 | 7 | 15 | |
| ZM00901 | SPZ90 | 90 | 94 | 1 | 50 | 28 | | | 16 | 1 | 10 | |
| ZM00902 | | | | 2 | 60 | 35 | | | 28 | 1 | 10 | |
| ZM00903 | | | | 3 | | | | | 40 | 7 | 15 | |
| ZM00951 | SPZ95 | 95 | 99 | 1 | 50 | 28 | | | 16 | 1 | 10 | |
| ZM00952 | | | | 2 | 60 | 35 | | | 28 | 1 | 15 | |
| ZM00953 | | | | 3 | | | | | 40 | 7 | 15 | |
| ZM01001 | SPZ100 | 100 | 104 | 1 | 50 | 28 | | | 16 | 1 | 10 | |
| ZM01002 | | | | 2 | 60 | 35 | | | 28 | 1 | 15 | |
| ZM01003 | | | | 3 | | | | | 40 | 7 | 15 | |
| ZM01061 | SPZ106 | 106 | 110 | 1 | 50 | 28 | | | 16 | 1 | 10 | |
| ZM01062 | | | | 2 | 60 | 35 | | | 28 | 1 | 15 | |
| ZM01063 | | | | 3 | | | | | 40 | 7 | 15 | |
| ZM01121 | SPZ112 | 112 | 116 | 1 | 50 | 28 | | | 16 | 1 | 10 | |
| ZM01122 | | | | 2 | 60 | 35 | | | 28 | 1 | 15 | |
| ZM01123 | | | | 3 | | | | | 40 | 7 | 15 | |
| ZM01181 | SPZ118 | 118 | 122 | 1 | 50 | 28 | 93 | 8 | 16 | 3 | 10 | |
| ZM01182 | | | | 2 | 60 | 35 | 91 | 8 | 28 | 3 | 15 | |
| ZM01183 | | | | 3 | | | | | 40 | 7 | 15 | |
| ZM01251 | SPZ125 | 125 | 129 | 1 | 50 | 28 | 100 | 8 | 16 | 3 | 15 | |
| ZM01252 | | | | 2 | 60 | 35 | 99 | 8 | 28 | 3 | 15 | |
| ZM01253 | | | | 3 | | | | | 40 | 7 | 15 | |

| Cod. interno Internal code Intern Code Code interne Código interno | Descrizione Description Beschreibung Description Descripción | P | O | Gole Grooves Rillen Gorges Canales | N | L | D | S | B | Forma Form Forme Forme Forma | d | Peso Weight Gewicht Poids Peso |
|--|--|------------|-----|--|----|----|-----|----|----|--|----|--|
| ZM01321 | SPZ132 | 132 | 136 | 1 | 50 | 28 | 106 | 8 | 16 | 3 | 15 | |
| ZM01322 | | | | 2 | 60 | 40 | 106 | 8 | 28 | 3 | 15 | |
| ZM01323 | | | | 3 | 60 | 40 | 106 | 8 | 40 | 8 | 15 | |
| ZM01401 | SPZ140 | 140 | 144 | 1 | 50 | 28 | 114 | 8 | 16 | 3 | 15 | |
| ZM01402 | | | | 2 | 60 | 40 | 114 | 8 | 28 | 3 | 15 | |
| ZM01403 | | | | 3 | 60 | 40 | 114 | 8 | 40 | 8 | 15 | |
| ZM01501 | SPZ150 | 150 | 154 | 1 | 50 | 28 | 124 | 8 | 16 | 3 | 15 | |
| ZM01502 | | | | 2 | 60 | 40 | 124 | 8 | 28 | 3 | 15 | |
| ZM01503 | | | | 3 | 60 | 40 | 124 | 8 | 40 | 8 | 20 | |
| ZM01601 | SPZ160 | 160 | 164 | 1 | 55 | 32 | 134 | 8 | 16 | 3 | 15 | |
| ZM01602 | | | | 2 | 60 | 40 | 134 | 8 | 28 | 3 | 15 | |
| ZM01603 | | | | 3 | 65 | 45 | 134 | 8 | 40 | 3 | 20 | |
| ZM01801 | SPZ180 | 180 | 184 | 1 | 55 | 32 | 154 | 8 | 16 | 5 | 20 | |
| ZM01802 | | | | 2 | 60 | 40 | 154 | 8 | 28 | 5 | 20 | |
| ZM01803 | | | | 3 | 65 | 45 | 154 | 8 | 40 | 5 | 20 | |
| ZM02001 | SPZ200 | 200 | 204 | 1 | 55 | 32 | 174 | 8 | 16 | 5 | 20 | |
| ZM02002 | | | | 2 | 60 | 40 | 174 | 8 | 28 | 5 | 20 | |
| ZM02003 | | | | 3 | 65 | 45 | 174 | 10 | 40 | 5 | 20 | |
| ZM02241 | SPZ224 | 224 | 228 | 1 | 55 | 32 | 198 | 8 | 16 | 5 | 20 | |
| ZM02242 | | | | 2 | 60 | 40 | 198 | 8 | 28 | 5 | 20 | |
| ZM02243 | | | | 3 | 65 | 45 | 198 | 10 | 40 | 5 | 20 | |
| ZM02501 | SPZ250 | 250 | 254 | 1 | 55 | 32 | 224 | 8 | 16 | 5 | 20 | |
| ZM02502 | | | | 2 | 60 | 40 | 224 | 10 | 28 | 5 | 20 | |
| ZM02503 | | | | 3 | 65 | 45 | 224 | 12 | 40 | 5 | 20 | |
| ZM02802 | SPZ280 | 280 | 284 | 2 | 65 | 45 | 254 | 10 | 28 | 5 | 20 | |
| ZM03152 | SPZ315 | 315 | 319 | 2 | 65 | 45 | 289 | 10 | 28 | 5 | 20 | |

| Cod. interno Internal code Intern Code Code interne Código interno | Descrizione Description Beschreibung Description Descripción | P | O | Gole Grooves Rillen Gorges Canales | N | L | D | S | B | Forma Form Forme Forme Forma | d | Peso Weight Gewicht Poids Peso |
|--|--|------------|-------|--|----|----|----|---|----|--|----|--|
| AM00401 | SPA40 | 40 | 45,5 | 1 | 40 | 35 | | | 20 | 1 | 10 | |
| AM00501 | SPA50 | 50 | 55,5 | 1 | 40 | 35 | | | 20 | 1 | 10 | |
| AM00502 | | | | 2 | 40 | 45 | | | 35 | 1 | 10 | |
| AM00561 | SPA56 | 56 | 61,5 | 1 | 40 | 35 | | | 20 | 1 | 10 | |
| AM00562 | | | | 2 | 40 | 45 | | | 35 | 1 | 10 | |
| AM00563 | | | | 3 | | | | | 50 | 7 | 10 | |
| AM00603 | SPA60 | 60 | 65,5 | 3 | | | | | 50 | 7 | 10 | |
| AM00631 | SPA63 | 63 | 68,5 | 1 | 40 | 35 | | | 20 | 1 | 10 | |
| AM00632 | | | | 2 | 40 | 45 | | | 35 | 1 | 10 | |
| AM00633 | | | | 3 | | | | | 50 | 7 | 10 | |
| AM00711 | SPA71 | 71 | 76,5 | 1 | 40 | 40 | | | 20 | 1 | 10 | |
| AM00712 | | | | 2 | 50 | 45 | | | 35 | 1 | 10 | |
| AM00713 | | | | 3 | | | | | 50 | 7 | 10 | |
| AM00751 | SPA75 | 75 | 80,5 | 1 | 40 | 40 | | | 20 | 1 | 10 | |
| AM00752 | | | | 2 | 50 | 45 | | | 35 | 1 | 10 | |
| AM00753 | | | | 3 | | | | | 50 | 7 | 10 | |
| AM00754 | | | | 4 | | | | | 65 | 7 | 10 | |
| AM00755 | | | | 5 | | | | | 80 | 7 | 10 | |
| AM00801 | SPA80 | 80 | 85,5 | 1 | 45 | 40 | | | 20 | 1 | 10 | |
| AM00802 | | | | 2 | 50 | 45 | | | 35 | 1 | 10 | |
| AM00803 | | | | 3 | | | | | 50 | 7 | 15 | |
| AM00804 | | | | 4 | | | | | 65 | 7 | 15 | |
| AM00805 | | | | 5 | | | | | 80 | 7 | 15 | |
| AM00851 | SPA85 | 85 | 90,5 | 1 | 45 | 40 | | | 20 | 1 | 10 | |
| AM00852 | | | | 2 | 50 | 45 | | | 35 | 1 | 10 | |
| AM00853 | | | | 3 | | | | | 50 | 7 | 15 | |
| AM00854 | | | | 4 | | | | | 65 | 7 | 15 | |
| AM00855 | | | | 5 | | | | | 80 | 7 | 15 | |
| AM00901 | SPA90 | 90 | 95,5 | 1 | 45 | 40 | | | 20 | 1 | 10 | |
| AM00902 | | | | 2 | 60 | 45 | | | 35 | 1 | 15 | |
| AM00903 | | | | 3 | | | | | 50 | 7 | 15 | |
| AM00904 | | | | 4 | | | | | 65 | 7 | 15 | |
| AM00905 | | | | 5 | | | | | 80 | 7 | 15 | |
| AM00951 | SPA95 | 95 | 100,5 | 1 | 45 | 40 | | | 20 | 1 | 10 | |
| AM00952 | | | | 2 | 60 | 45 | | | 35 | 1 | 15 | |
| AM00953 | | | | 3 | | | | | 50 | 7 | 15 | |
| AM00954 | | | | 4 | | | | | 65 | 7 | 15 | |
| AM00955 | | | | 5 | | | | | 80 | 7 | 15 | |
| AM01001 | SPA100 | 100 | 105,5 | 1 | 48 | 40 | | | 20 | 1 | 10 | |
| AM01002 | | | | 2 | 60 | 45 | | | 35 | 1 | 15 | |
| AM01003 | | | | 3 | | | | | 50 | 7 | 15 | |
| AM01004 | | | | 4 | | 52 | 67 | | 65 | 2 | 15 | |
| AM01005 | | | | 5 | | 52 | 67 | | 80 | 2 | 15 | |
| AM01061 | SPA106 | 106 | 111,5 | 1 | 48 | 40 | | | 20 | 1 | 10 | |
| AM01062 | | | | 2 | 60 | 45 | | | 35 | 1 | 15 | |
| AM01063 | | | | 3 | | | | | 50 | 7 | 15 | |
| AM01065 | | | | 5 | | 52 | 67 | | 80 | 2 | 15 | |
| AM01121 | SPA112 | 112 | 117,5 | 1 | 48 | 40 | | | 20 | 1 | 10 | |
| AM01122 | | | | 2 | 60 | 45 | | | 35 | 1 | 15 | |
| AM01123 | | | | 3 | | | | | 50 | 7 | 15 | |
| AM01124 | | | | 4 | | 52 | 79 | | 65 | 2 | 15 | |
| AM01125 | | | | 5 | | 52 | 79 | | 80 | 2 | 15 | |
| AM01181 | SPA118 | 118 | 123,5 | 1 | 60 | 40 | | | 20 | 1 | 15 | |
| AM01182 | | | | 2 | 60 | 45 | | | 35 | 1 | 15 | |
| AM01183 | | | | 3 | | | | | 50 | 7 | 15 | |
| AM01184 | | | | 4 | | 52 | 87 | | 65 | 2 | 15 | |
| AM01185 | | | | 5 | | 52 | 87 | | 80 | 2 | 15 | |

| Cod. interno Internal code Intern Code Code interne Código interno | Descrizione Description Beschreibung Description Descripción | P | O | Gole Grooves Rillen Gorges Canales | N | L | D | S | B | Forma Form Forme Forme Forma | d | Peso Weight Gewicht Poids Peso |
|--|--|------------|-------|--|-----|----|-----|----|----|--|----|--|
| AM01251 | SPA125 | 125 | 130,5 | 1 | 60 | 40 | | | 20 | 1 | 15 | |
| AM01252 | | | | 2 | 60 | 45 | | | 35 | 1 | 15 | |
| AM01253 | | | | 3 | | | | | 50 | 7 | 15 | |
| AM01254 | | | | 4 | | 52 | 97 | | 65 | 2 | 15 | |
| AM01321 | SPA132 | 132 | 137,5 | 1 | 60 | 40 | | | 20 | 1 | 15 | |
| AM01322 | | | | 2 | 60 | 45 | | | 35 | 1 | 15 | |
| AM01323 | | | | 3 | | | | | 50 | 7 | 15 | |
| AM01324 | | | | 4 | | 52 | 97 | | 65 | 2 | 15 | |
| AM01325 | | | | 5 | | 52 | 97 | | 80 | 2 | 15 | |
| AM01401 | SPA140 | 140 | 145,5 | 1 | 60 | 40 | 107 | 10 | 20 | 3 | 15 | |
| AM01402 | | | | 2 | 60 | 45 | 107 | 10 | 35 | 3 | 15 | |
| AM01403 | | | | 3 | 65 | 52 | 107 | 18 | 50 | 3 | 20 | |
| AM01404 | | | | 4 | | 52 | 107 | | 65 | 2 | 20 | |
| AM01405 | | | | 5 | | 52 | 107 | | 80 | 2 | 20 | |
| AM01501 | SPA150 | 150 | 155,5 | 1 | 60 | 40 | 117 | 10 | 20 | 3 | 15 | |
| AM01502 | | | | 2 | 60 | 45 | 117 | 10 | 35 | 3 | 15 | |
| AM01503 | | | | 3 | 65 | 52 | 117 | 18 | 50 | 3 | 20 | |
| AM01504 | | | | 4 | | 52 | 117 | | 65 | 2 | 20 | |
| AM01505 | | | | 5 | | 52 | 117 | | 80 | 2 | 20 | |
| AM01601 | SPA160 | 160 | 165,5 | 1 | 60 | 40 | 127 | 10 | 20 | 3 | 15 | |
| AM01602 | | | | 2 | 60 | 45 | 127 | 10 | 35 | 3 | 15 | |
| AM01603 | | | | 3 | 70 | 52 | 127 | 18 | 50 | 3 | 20 | |
| AM01604 | | | | 4 | 70 | 52 | 127 | 22 | 65 | 4 | 20 | |
| AM01605 | | | | 5 | 80 | 52 | 127 | 22 | 80 | 4 | 20 | |
| AM01701 | SPA170 | 170 | 175,5 | 1 | 60 | 40 | 137 | 10 | 20 | 3 | 15 | |
| AM01702 | | | | 2 | 60 | 45 | 137 | 10 | 35 | 3 | 15 | |
| AM01703 | | | | 3 | 70 | 52 | 137 | 18 | 50 | 3 | 20 | |
| AM01704 | | | | 4 | 80 | 52 | 137 | 18 | 65 | 4 | 20 | |
| AM01705 | | | | 5 | 80 | 52 | 137 | 18 | 80 | 4 | 20 | |
| AM01801 | SPA180 | 180 | 185,5 | 1 | 65 | 40 | 147 | 10 | 20 | 3 | 20 | |
| AM01802 | | | | 2 | 70 | 50 | 147 | 12 | 35 | 3 | 20 | |
| AM01803 | | | | 3 | 70 | 52 | 147 | 12 | 50 | 3 | 20 | |
| AM01804 | | | | 4 | 80 | 60 | 147 | 22 | 65 | 4 | 20 | |
| AM01805 | | | | 5 | 80 | 65 | 147 | 22 | 80 | 4 | 20 | |
| AM01902 | SPA190 | 190 | 195,5 | 2 | 70 | 50 | 157 | 12 | 35 | 3 | 20 | |
| AM01903 | | | | 3 | 70 | 52 | 157 | 12 | 50 | 3 | 20 | |
| AM01904 | | | | 4 | 80 | 60 | 157 | 18 | 65 | 4 | 20 | |
| AM02001 | SPA200 | 200 | 205,5 | 1 | 65 | 45 | 167 | 10 | 20 | 3 | 20 | |
| AM02002 | | | | 2 | 70 | 50 | 167 | 12 | 35 | 3 | 20 | |
| AM02003 | | | | 3 | 70 | 52 | 167 | 12 | 50 | 3 | 20 | |
| AM02004 | | | | 4 | 80 | 60 | 167 | 18 | 65 | 4 | 20 | |
| AM02005 | | | | 5 | 80 | 65 | 167 | 20 | 80 | 4 | 20 | |
| AM02121 | SPA212 | 212 | 217,5 | 1 | 65 | 40 | | 10 | 20 | 3 | 20 | |
| AM02122 | | | | 2 | 70 | 45 | | 12 | 35 | 3 | 20 | |
| AM02241 | SPA224 | 224 | 229,5 | 1 | 65 | 45 | 192 | 10 | 20 | 3 | 20 | |
| AM02242 | | | | 2 | 70 | 50 | 192 | 12 | 35 | 3 | 20 | |
| AM02243 | | | | 3 | 80 | 52 | 192 | 12 | 50 | 3 | 20 | |
| AM02244 | | | | 4 | 90 | 60 | 192 | 18 | 65 | 4 | 20 | |
| AM02245 | | | | 5 | 90 | 65 | 192 | 20 | 80 | 4 | 20 | |
| AM02361 | SPA236 | 236 | 241,5 | 1 | | 50 | | 12 | 20 | 3 | 20 | |
| AM02362 | | | | 2 | | 50 | | 12 | 35 | 3 | 20 | |
| AM02501 | SPA250 | 250 | 255,5 | 1 | 75 | 50 | 217 | 12 | 20 | 3 | 20 | |
| AM02502 | | | | 2 | 75 | 50 | 217 | 12 | 35 | 3 | 20 | |
| AM02503 | | | | 3 | 80 | 60 | 217 | 12 | 50 | 3 | 20 | |
| AM02504 | | | | 4 | 90 | 65 | 217 | 18 | 65 | 3 | 20 | |
| AM02505 | | | | 5 | 90 | 65 | 217 | 20 | 80 | 4 | 20 | |
| AM02801 | SPA280 | 280 | 285,5 | 1 | 75 | 50 | 247 | 14 | 20 | 5 | 20 | |
| AM02802 | | | | 2 | 80 | 50 | 247 | 14 | 35 | 5 | 20 | |
| AM02803 | | | | 3 | 80 | 60 | 247 | 14 | 50 | 5 | 20 | |
| AM02804 | | | | 4 | 90 | 65 | 247 | 16 | 65 | 5 | 20 | |
| AM02805 | | | | 5 | 100 | 65 | 247 | 18 | 80 | 6 | 25 | |

| Cod. interno Internal code Code interne Código interno | Descrizione Description Beschreibung Description Descripción | P | O | Gole Grooves Rillen Gorges Canales | N | L | D | S | B | Forma Form Forme Forme Forma | d | Peso Weight Gewicht Poids Peso |
|---|--|------------|-------|--|-----|----|-----|----|----|--|----|--|
| AM03001 | SPA300 | 300 | 305,5 | 1 | 75 | 50 | 267 | 14 | 20 | 5 | 20 | |
| AM03002 | | | | 2 | 80 | 50 | 267 | 14 | 35 | 5 | 20 | |
| AM03003 | | | | 3 | 80 | 60 | 267 | 14 | 50 | 5 | 20 | |
| AM03004 | | | | 4 | 90 | 65 | 267 | 16 | 65 | 5 | 20 | |
| AM03005 | | | | 5 | 100 | 65 | 267 | 18 | 80 | 6 | 25 | |
| AM03151 | SPA315 | 315 | 320,5 | 1 | 75 | 60 | 282 | 14 | 20 | 5 | 20 | |
| AM03152 | | | | 2 | 80 | 50 | 282 | 14 | 35 | 5 | 20 | |
| AM03153 | | | | 3 | 90 | 60 | 282 | 14 | 50 | 5 | 20 | |
| AM03154 | | | | 4 | 90 | 65 | 282 | 16 | 65 | 5 | 20 | |
| AM03155 | | | | 5 | 100 | 65 | 282 | 18 | 80 | 6 | 25 | |
| AM03551 | SPA355 | 355 | 360,5 | 1 | 75 | 50 | 322 | 14 | 20 | 5 | 20 | |
| AM03552 | | | | 2 | 80 | 50 | 322 | 14 | 35 | 5 | 20 | |
| AM03553 | | | | 3 | 90 | 60 | 322 | 14 | 50 | 5 | 20 | |
| AM03554 | | | | 4 | 90 | 65 | 322 | 16 | 65 | 5 | 25 | |
| AM03555 | | | | 5 | 100 | 65 | 322 | 18 | 80 | 6 | 25 | |
| AM04001 | SPA400 | 400 | 405,5 | 1 | 90 | 50 | 367 | 14 | 20 | 5 | 20 | |
| AM04002 | | | | 2 | 90 | 50 | 367 | 14 | 35 | 5 | 20 | |
| AM04003 | | | | 3 | 100 | 60 | 367 | 16 | 50 | 5 | 25 | |
| AM04004 | | | | 4 | 100 | 65 | 367 | 20 | 65 | 5 | 25 | |
| AM04005 | | | | 5 | 100 | 65 | 367 | 22 | 80 | 6 | 25 | |
| AM04501 | SPA450 | 450 | 455,5 | 1 | 90 | 50 | 417 | 14 | 20 | 5 | 20 | |
| AM04502 | | | | 2 | 100 | 50 | 417 | 14 | 35 | 5 | 25 | |
| AM04503 | | | | 3 | 100 | 60 | 417 | 16 | 50 | 5 | 25 | |
| AM04504 | | | | 4 | 105 | 65 | 417 | 20 | 65 | 6 | 25 | |
| AM04505 | | | | 5 | 105 | 65 | 417 | 22 | 80 | 6 | 25 | |
| AM05001 | SPA500 | 500 | 505,5 | 1 | 90 | 50 | 467 | 14 | 20 | 5 | 20 | |
| AM05002 | | | | 2 | 100 | 50 | 467 | 16 | 35 | 5 | 25 | |
| AM05003 | | | | 3 | 105 | 60 | 467 | 20 | 50 | 5 | 25 | |
| AM05004 | | | | 4 | 105 | 65 | 467 | 20 | 65 | 6 | 25 | |
| AM05005 | | | | 5 | 110 | 65 | 467 | 22 | 80 | 6 | 25 | |
| AM05601 | SPA560 | 560 | 565,5 | 1 | 100 | 50 | 527 | 15 | 20 | 5 | 25 | |
| AM05602 | | | | 2 | 100 | 50 | 527 | 18 | 35 | 5 | 25 | |
| AM05603 | | | | 3 | 120 | 65 | 527 | 20 | 50 | 5 | 25 | |
| AM05604 | | | | 4 | 120 | 65 | 527 | 22 | 65 | 5 | 25 | |
| AM05605 | | | | 5 | 120 | 80 | 527 | 24 | 80 | 5 | 25 | |
| AM05606 | | | | 6 | 120 | 80 | 527 | 26 | 95 | 6 | 25 | |
| AM06301 | SPA630 | 630 | 635,5 | 1 | 100 | 50 | 597 | 16 | 20 | 5 | 25 | |
| AM06302 | | | | 2 | 110 | 50 | 597 | 18 | 35 | 5 | 25 | |
| AM06303 | | | | 3 | 120 | 65 | 597 | 20 | 50 | 5 | 25 | |
| AM06304 | | | | 4 | 120 | 65 | 597 | 22 | 65 | 5 | 25 | |
| AM06305 | | | | 5 | 120 | 80 | 597 | 24 | 80 | 5 | 25 | |
| AM06306 | | | | 6 | 120 | 80 | 597 | 26 | 95 | 6 | 25 | |

| Cod. interno Internal code Internor Code Code interne Código interno | Descrizione Description Beschreibung Description Descripción | P | O | Gole Grooves Rillen Gorges Canales | N | L | D | S | B | Forma Form Forme Forme Forma | d | Peso Weight Gewicht Poids Peso |
|--|--|------------|-----|--|----|----|-----|---|-----|--|----|--|
| BM00631 | SPB63 | 63 | 70 | 1 | 45 | 45 | | | 25 | 1 | 10 | |
| BM00701 | SPB70 | 70 | 77 | 1 | 45 | 45 | | | 25 | 1 | 10 | |
| BM00702 | | | | 2 | 45 | 55 | | | 44 | 1 | 10 | |
| BM00713 | SPB71 | 71 | 78 | 3 | | | | | 63 | 7 | 15 | |
| BM00801 | SPB80 | 80 | 87 | 1 | 50 | 45 | | | 25 | 1 | 10 | |
| BM00802 | | | | 2 | 50 | 55 | | | 44 | 1 | 10 | |
| BM00803 | | | | 3 | | | | | 63 | 7 | 15 | |
| BM00804 | | | | 4 | | | | | 82 | 7 | 15 | |
| BM00805 | | | | 5 | | | | | 101 | 7 | 15 | |
| BM00851 | SPB85 | 85 | 92 | 1 | 50 | 45 | | | 25 | 1 | 10 | |
| BM00852 | | | | 2 | 50 | 55 | | | 44 | 1 | 10 | |
| BM00853 | | | | 3 | - | - | | | 63 | 7 | 15 | |
| BM00901 | SPB90 | 90 | 97 | 1 | 50 | 45 | | | 25 | 1 | 10 | |
| BM00902 | | | | 2 | 50 | 55 | | | 44 | 1 | 10 | |
| BM00903 | | | | 3 | | | | | 63 | 7 | 15 | |
| BM00904 | | | | 4 | | | | | 82 | 7 | 15 | |
| BM00905 | | | | 5 | | | | | 101 | 7 | 15 | |
| BM00951 | SPB95 | 95 | 102 | 1 | 50 | 45 | | | 25 | 1 | 10 | |
| BM01001 | SPB100 | 100 | 107 | 1 | 52 | 45 | | | 25 | 1 | 10 | |
| BM01002 | | | | 2 | 55 | 55 | | | 44 | 1 | 15 | |
| BM01003 | | | | 3 | | | | | 63 | 7 | 15 | |
| BM01004 | | | | 4 | | | | | 82 | 7 | 15 | |
| BM01005 | | | | 5 | | | | | 101 | 7 | 15 | |
| BM01061 | SPB106 | 106 | 113 | 1 | | 45 | | | 25 | 1 | 15 | |
| BM01062 | | | | 2 | | 55 | | | 44 | 1 | 15 | |
| BM01121 | SPB112 | 112 | 119 | 1 | 55 | 45 | | | 25 | 1 | 15 | |
| BM01122 | | | | 2 | 60 | 55 | | | 44 | 1 | 15 | |
| BM01123 | | | | 3 | | | | | 63 | 7 | 15 | |
| BM01124 | | | | 4 | | | | | 82 | 7 | 20 | |
| BM01125 | | | | 5 | | | | | 101 | 7 | 20 | |
| BM01181 | SPB118 | 118 | 125 | 1 | 55 | 45 | | | 25 | 1 | 15 | |
| BM01182 | | | | 2 | 60 | 55 | | | 44 | 1 | 15 | |
| BM01183 | | | | 3 | | | | | 63 | 7 | 15 | |
| BM01184 | | | | 4 | | | | | 82 | 7 | 20 | |
| BM01185 | | | | 5 | | | | | 101 | 7 | 20 | |
| BM01186 | | | | 6 | | | | | 120 | 7 | 20 | |
| BM01201 | SPB120 | 120 | 127 | 1 | 55 | 45 | | | 25 | 1 | 15 | |
| BM01202 | | | | 2 | 60 | 55 | | | 44 | 1 | 15 | |
| BM01203 | | | | 3 | | | | | 63 | 7 | 15 | |
| BM01204 | | | | 4 | | | | | 82 | 7 | 20 | |
| BM01205 | | | | 5 | | | | | 101 | 7 | 20 | |
| BM01206 | | | | 6 | | | | | 120 | 7 | 20 | |
| BM01251 | SPB125 | 125 | 132 | 1 | 58 | 45 | | | 25 | 1 | 10 | |
| BM01252 | | | | 2 | 60 | 55 | | | 44 | 1 | 15 | |
| BM01253 | | | | 3 | | 60 | 83 | | 63 | 2 | 15 | |
| BM01254 | | | | 4 | | 60 | 83 | | 82 | 2 | 20 | |
| BM01255 | | | | 5 | | 60 | 83 | | 101 | 2 | 20 | |
| BM01256 | | | | 6 | | 60 | 83 | | 120 | 2 | 20 | |
| BM01321 | SPB132 | 132 | 139 | 1 | 60 | 45 | | | 25 | 1 | 15 | |
| BM01322 | | | | 2 | 60 | 55 | | | 44 | 1 | 15 | |
| BM01323 | | | | 3 | | 60 | 88 | | 63 | 2 | 15 | |
| BM01324 | | | | 4 | | 60 | 88 | | 82 | 2 | 20 | |
| BM01325 | | | | 5 | | 60 | 88 | | 101 | 2 | 20 | |
| BM01326 | | | | 6 | | 60 | 88 | | 120 | 2 | 20 | |
| BM01401 | SPB140 | 140 | 147 | 1 | 65 | 45 | | | 25 | 1 | 20 | |
| BM01402 | | | | 2 | 65 | 55 | | | 44 | 1 | 20 | |
| BM01403 | | | | 3 | | 60 | 98 | | 63 | 2 | 20 | |
| BM01404 | | | | 4 | | 60 | 98 | | 82 | 2 | 20 | |
| BM01405 | | | | 5 | | 60 | 98 | | 101 | 2 | 20 | |
| BM01406 | | | | 6 | | 60 | 98 | | 120 | 2 | 20 | |
| BM01501 | SPB150 | 150 | 157 | 1 | 65 | 45 | | | 25 | 1 | 20 | |
| BM01502 | | | | 2 | 65 | 55 | | | 44 | 1 | 20 | |
| BM01503 | | | | 3 | | 60 | 108 | | 63 | 2 | 20 | |
| BM01504 | | | | 4 | | 60 | 108 | | 82 | 2 | 20 | |
| BM01505 | | | | 5 | | 60 | 108 | | 101 | 2 | 20 | |
| BM01506 | | | | 6 | | 60 | 108 | | 120 | 2 | 20 | |

| Cod. interno Internal code Intern Code Code interne Código interno | Descrizione Description Beschreibung Description Descripción | P | O | Gole Grooves Rillen Gorges Canales | N | L | D | S | B | Forma Form Forme Forme Forma | d | Peso Weight Gewicht Poids Peso |
|--|--|------------|-----|--|-----|----|-----|----|-----|--|----|--|
| BM01601 | SPB160 | 160 | 167 | 1 | 65 | 45 | 118 | 12 | 25 | 3 | 20 | |
| BM01602 | | | | 2 | 70 | 55 | 118 | 12 | 44 | 3 | 20 | |
| BM01603 | | | | 3 | | 60 | 118 | | 63 | 2 | 20 | |
| BM01604 | | | | 4 | | 60 | 118 | | 82 | 2 | 20 | |
| BM01605 | | | | 5 | | 60 | 118 | | 101 | 2 | 20 | |
| BM01606 | | | | 6 | | 65 | 118 | | 120 | 2 | 20 | |
| BM01701 | SPB170 | 170 | 177 | 1 | 65 | 45 | 128 | 12 | 25 | 3 | 20 | |
| BM01702 | | | | 2 | 70 | 55 | 128 | 12 | 44 | 3 | 20 | |
| BM01703 | | | | 3 | 70 | 60 | 128 | 30 | 63 | 4 | 20 | |
| BM01704 | | | | 4 | 70 | 60 | 128 | 30 | 82 | 4 | 20 | |
| BM01705 | | | | 5 | 70 | 60 | 128 | 30 | 101 | 4 | 20 | |
| BM01706 | | | | 6 | 70 | 65 | 128 | 40 | 120 | 4 | 20 | |
| BM01801 | SPB180 | 180 | 187 | 1 | 65 | 45 | 138 | 12 | 25 | 3 | 20 | |
| BM01802 | | | | 2 | 70 | 55 | 138 | 12 | 44 | 3 | 20 | |
| BM01803 | | | | 3 | 80 | 60 | 138 | 18 | 63 | 4 | 20 | |
| BM01804 | | | | 4 | 80 | 60 | 138 | 30 | 82 | 4 | 20 | |
| BM01805 | | | | 5 | 80 | 70 | 138 | 40 | 101 | 4 | 20 | |
| BM01806 | | | | 6 | 80 | 70 | 138 | 40 | 120 | 4 | 20 | |
| BM01901 | SPB190 | 190 | 197 | 1 | 65 | 45 | 148 | 12 | 25 | 3 | 20 | |
| BM01902 | | | | 2 | 70 | 55 | 148 | 12 | 44 | 3 | 20 | |
| BM02001 | SPB200 | 200 | 207 | 1 | 70 | 45 | 158 | 14 | 25 | 3 | 20 | |
| BM02002 | | | | 2 | 70 | 55 | 158 | 12 | 44 | 3 | 20 | |
| BM02003 | | | | 3 | 80 | 60 | 158 | 18 | 63 | 4 | 20 | |
| BM02004 | | | | 4 | 88 | 60 | 158 | 25 | 82 | 4 | 20 | |
| BM02005 | | | | 5 | 96 | 70 | 158 | 35 | 101 | 4 | 25 | |
| BM02006 | | | | 6 | 96 | 70 | 158 | 40 | 120 | 4 | 25 | |
| BM02121 | SPB212 | 212 | 219 | 1 | 70 | 45 | 170 | 14 | 25 | 3 | 20 | |
| BM02122 | | | | 2 | 77 | 55 | 170 | 14 | 44 | 3 | 20 | |
| BM02123 | | | | 3 | 80 | 60 | 170 | 18 | 63 | 4 | 20 | |
| BM02124 | | | | 4 | 88 | 60 | 170 | 25 | 82 | 4 | 20 | |
| BM02125 | | | | 5 | 96 | 70 | 170 | 30 | 101 | 4 | 25 | |
| BM02126 | | | | 6 | 104 | 80 | 170 | 45 | 120 | 4 | 25 | |
| BM02241 | SPB224 | 224 | 231 | 1 | 70 | 45 | 183 | 14 | 25 | 3 | 20 | |
| BM02242 | | | | 2 | 77 | 55 | 183 | 14 | 44 | 3 | 20 | |
| BM02243 | | | | 3 | 80 | 60 | 183 | 18 | 63 | 4 | 20 | |
| BM02244 | | | | 4 | 88 | 60 | 183 | 25 | 82 | 4 | 20 | |
| BM02245 | | | | 5 | 96 | 70 | 183 | 25 | 101 | 4 | 25 | |
| BM02246 | | | | 6 | 104 | 80 | 183 | 30 | 120 | 4 | 25 | |
| BM02501 | SPB250 | 250 | 257 | 1 | 70 | 50 | 208 | 14 | 25 | 3 | 20 | |
| BM02502 | | | | 2 | 77 | 55 | 208 | 14 | 44 | 3 | 20 | |
| BM02503 | | | | 3 | 80 | 60 | 208 | 18 | 63 | 4 | 20 | |
| BM02504 | | | | 4 | 96 | 65 | 208 | 25 | 82 | 4 | 25 | |
| BM02505 | | | | 5 | 104 | 75 | 208 | 25 | 101 | 4 | 25 | |
| BM02506 | | | | 6 | 104 | 80 | 208 | 25 | 120 | 4 | 25 | |
| BM02801 | SPB280 | 280 | 287 | 1 | 76 | 50 | 238 | 14 | 25 | 3 | 20 | |
| BM02802 | | | | 2 | 80 | 55 | 238 | 14 | 44 | 3 | 20 | |
| BM02803 | | | | 3 | 90 | 60 | 238 | 18 | 63 | 4 | 20 | |
| BM02804 | | | | 4 | 96 | 65 | 238 | 25 | 82 | 4 | 25 | |
| BM02805 | | | | 5 | 104 | 75 | 238 | 25 | 101 | 4 | 25 | |
| BM02806 | | | | 6 | 104 | 80 | 238 | 25 | 120 | 4 | 25 | |
| BM03001 | SPB300 | 300 | 307 | 1 | 76 | 50 | 258 | 15 | 25 | 5 | 20 | |
| BM03002 | | | | 2 | 80 | 55 | 258 | 15 | 44 | 5 | 20 | |
| BM03003 | | | | 3 | 90 | 60 | 258 | 18 | 63 | 6 | 20 | |
| BM03004 | | | | 4 | 96 | 65 | 258 | 20 | 82 | 6 | 25 | |
| BM03005 | | | | 5 | 104 | 75 | 258 | 22 | 101 | 6 | 25 | |
| BM03006 | | | | 6 | 104 | 80 | 258 | 24 | 120 | 6 | 25 | |

| Cod. interno Internal code Intern Code Code interne Código interno | Descrizione Description Beschreibung Description Descripción | P | O | Gole Grooves Rillen Gorges Canales | N | L | D | S | B | Forma Form Forme Forme Forma | d | Peso Weight Gewicht Poids Peso |
|--|--|------------|-----|--|-----|-----|-----|----|-----|--|----|--|
| BM03151 | SPB315 | 315 | 322 | 1 | 76 | 50 | 273 | 15 | 25 | 5 | 20 | |
| BM03152 | | | | 2 | 88 | 60 | 273 | 15 | 44 | 5 | 20 | |
| BM03153 | | | | 3 | 90 | 60 | 273 | 18 | 63 | 6 | 20 | |
| BM03154 | | | | 4 | 96 | 65 | 273 | 20 | 82 | 6 | 25 | |
| BM03155 | | | | 5 | 104 | 75 | 273 | 22 | 101 | 6 | 25 | |
| BM03156 | | | | 6 | 120 | 90 | 273 | 24 | 120 | 6 | 25 | |
| BM03551 | SPB355 | 355 | 362 | 1 | 80 | 50 | 313 | 15 | 25 | 5 | 20 | |
| BM03552 | | | | 2 | 88 | 60 | 313 | 15 | 44 | 5 | 20 | |
| BM03553 | | | | 3 | 92 | 60 | 313 | 18 | 63 | 6 | 25 | |
| BM03554 | | | | 4 | 96 | 65 | 313 | 20 | 82 | 6 | 25 | |
| BM03555 | | | | 5 | 104 | 75 | 313 | 22 | 101 | 6 | 25 | |
| BM03556 | | | | 6 | 120 | 90 | 313 | 24 | 120 | 6 | 25 | |
| BM04001 | SPB400 | 400 | 407 | 1 | 85 | 55 | 358 | 18 | 25 | 5 | 20 | |
| BM04002 | | | | 2 | 88 | 60 | 358 | 18 | 44 | 5 | 20 | |
| BM04003 | | | | 3 | 96 | 65 | 358 | 22 | 63 | 5 | 25 | |
| BM04004 | | | | 4 | 104 | 75 | 358 | 24 | 82 | 6 | 25 | |
| BM04005 | | | | 5 | 112 | 85 | 358 | 26 | 101 | 6 | 25 | |
| BM04006 | | | | 6 | 120 | 100 | 358 | 28 | 120 | 6 | 25 | |
| BM04253 | SPB425 | 425 | 432 | 3 | 96 | 65 | 383 | 22 | 63 | 5 | 20 | |
| BM04254 | | | | 4 | 104 | 75 | 383 | 24 | 82 | 6 | 25 | |
| BM04255 | | | | 5 | 112 | 85 | 383 | 26 | 101 | 6 | 25 | |
| BM04501 | SPB450 | 450 | 457 | 1 | 90 | 60 | 408 | 18 | 25 | 5 | 20 | |
| BM04502 | | | | 2 | 90 | 60 | 408 | 18 | 44 | 5 | 20 | |
| BM04503 | | | | 3 | 96 | 65 | 408 | 22 | 63 | 5 | 25 | |
| BM04504 | | | | 4 | 104 | 75 | 408 | 24 | 82 | 6 | 25 | |
| BM04505 | | | | 5 | 112 | 85 | 408 | 26 | 101 | 6 | 25 | |
| BM04506 | | | | 6 | 120 | 100 | 408 | 28 | 120 | 6 | 25 | |
| BM05001 | SPB500 | 500 | 507 | 1 | 100 | 60 | 458 | 18 | 25 | 5 | 25 | |
| BM05002 | | | | 2 | 100 | 65 | 458 | 20 | 44 | 5 | 25 | |
| BM05003 | | | | 3 | 104 | 75 | 458 | 24 | 63 | 5 | 25 | |
| BM05004 | | | | 4 | 112 | 85 | 458 | 28 | 82 | 5 | 25 | |
| BM05005 | | | | 5 | 120 | 90 | 458 | 30 | 101 | 6 | 25 | |
| BM05006 | | | | 6 | 128 | 105 | 458 | 33 | 120 | 6 | 25 | |
| BM05601 | SPB560 | 560 | 567 | 1 | 100 | 60 | 518 | 18 | 25 | 5 | 25 | |
| BM05602 | | | | 2 | 100 | 65 | 518 | 20 | 44 | 5 | 25 | |
| BM05603 | | | | 3 | 104 | 75 | 518 | 24 | 63 | 5 | 25 | |
| BM05604 | | | | 4 | 112 | 85 | 518 | 28 | 82 | 5 | 25 | |
| BM05605 | | | | 5 | 120 | 90 | 518 | 30 | 101 | 6 | 25 | |
| BM05606 | | | | 6 | 128 | 105 | 518 | 33 | 120 | 6 | 25 | |
| BM06001 | SPB600 | 600 | 607 | 1 | 100 | 60 | 558 | 18 | 25 | 5 | 25 | |
| BM06002 | | | | 2 | 100 | 65 | 558 | 20 | 44 | 5 | 25 | |
| BM06003 | | | | 3 | 104 | 75 | 558 | 24 | 63 | 5 | 25 | |
| BM06004 | | | | 4 | 115 | 85 | 558 | 28 | 82 | 5 | 25 | |
| BM06005 | | | | 5 | 120 | 90 | 558 | 30 | 101 | 6 | 25 | |
| BM06006 | | | | 6 | 129 | 105 | 558 | 33 | 120 | 6 | 25 | |
| BM06301 | SPB630 | 630 | 637 | 1 | 100 | 60 | 588 | 18 | 25 | 5 | 25 | |
| BM06302 | | | | 2 | 100 | 65 | 588 | 20 | 44 | 5 | 25 | |
| BM06303 | | | | 3 | 105 | 75 | 588 | 26 | 63 | 5 | 25 | |
| BM06304 | | | | 4 | 120 | 85 | 588 | 28 | 82 | 5 | 25 | |
| BM06305 | | | | 5 | 128 | 90 | 588 | 30 | 101 | 6 | 25 | |
| BM06306 | | | | 6 | 140 | 105 | 588 | 33 | 120 | 6 | 25 | |

| Cod. interno Internal code Intern Code Code interne Código interno | Descrizione Description Beschreibung Description Descripción | P | O | Gole Grooves Rillen Gorges Canales | N | L | D | S | B | Forma Form Forme Forme Forma | d | Peso Weight Gewicht Poids Peso | | | | | | | |
|--|--|------------|-------|--|----|----|-----|----|------|--|----|--|------|------|-------|------|-------|----|----|
| CM01001 | SPC100 | 100 | 109,6 | 1 | 60 | 50 | | | 34,0 | 1 | 15 | | | | | | | | |
| CM01201 | SPC120 | 120 | 129,6 | 1 | 65 | 50 | | | 34,0 | 1 | 15 | | | | | | | | |
| CM01202 | | | | 2 | | | | | | | | | 59,5 | 7 | 15 | | | | |
| CM01401 | SPC140 | 140 | 149,6 | 1 | 70 | 50 | | | 34,0 | 1 | 20 | | | | | | | | |
| CM01402 | | | | 2 | | | | | | | | | 59,5 | 7 | 20 | | | | |
| CM01403 | | | | 3 | | | | | | | | | 65 | 83 | 85,0 | 2 | 20 | | |
| CM01404 | | | | 4 | | | | | | | | | 80 | 83 | 110,5 | 2 | 20 | | |
| CM01501 | SPC150 | 150 | 159,6 | 1 | 70 | 50 | | | 34,0 | 1 | 20 | | | | | | | | |
| CM01502 | | | | 2 | | | | | | | | | 59,5 | 7 | 20 | | | | |
| CM01503 | | | | 3 | | | | | | | | | 65 | 93 | 85,0 | 2 | 20 | | |
| CM01504 | | | | 4 | | | | | | | | | 80 | 93 | 110,5 | 2 | 20 | | |
| CM01505 | | | | 5 | | | | | | | | | 96 | 93 | 136,0 | 2 | 20 | | |
| CM01601 | SPC160 | 160 | 169,6 | 1 | 72 | 50 | 103 | | 34,0 | 1 | 20 | | | | | | | | |
| CM01602 | | | | 2 | | | | | | | | | 103 | 59,5 | 7 | 20 | | | |
| CM01603 | | | | 3 | | | | | | | | | 65 | 103 | 85,0 | 2 | 20 | | |
| CM01604 | | | | 4 | | | | | | | | | 80 | 103 | 110,5 | 2 | 20 | | |
| CM01605 | | | | 5 | | | | | | | | | 96 | 103 | 136,0 | 2 | 20 | | |
| CM01606 | | | | 6 | | | | | | | | | 96 | 103 | 161,5 | 2 | 20 | | |
| CM01801 | SPC180 | 180 | 189,6 | 1 | 76 | 50 | 123 | 16 | 34,0 | 3 | 20 | | | | | | | | |
| CM01802 | | | | 2 | | | | | | | | | 80 | 123 | 30 | 59,5 | 8 | 20 | |
| CM01803 | | | | 3 | | | | | | | | | 82 | 65 | 123 | 35 | 85,0 | 4 | 20 |
| CM01804 | | | | 4 | | | | | | | | | 82 | 80 | 123 | 60 | 110,5 | 4 | 20 |
| CM01805 | | | | 5 | | | | | | | | | 82 | 96 | 123 | 75 | 136,0 | 4 | 20 |
| CM01806 | | | | 6 | | | | | | | | | 82 | 96 | 123 | 75 | 161,5 | 4 | 20 |
| CM02001 | SPC200 | 200 | 209,6 | 1 | 76 | 50 | 143 | 16 | 34,0 | 3 | 20 | | | | | | | | |
| CM02002 | | | | 2 | | | | | | | | | 80 | 60 | 143 | 20 | 59,5 | 3 | 20 |
| CM02003 | | | | 3 | | | | | | | | | 86 | 65 | 143 | 25 | 85,0 | 4 | 20 |
| CM02004 | | | | 4 | | | | | | | | | 90 | 90 | 143 | 70 | 110,5 | 4 | 20 |
| CM02005 | | | | 5 | | | | | | | | | 90 | 100 | 143 | 80 | 136,0 | 4 | 25 |
| CM02006 | | | | 6 | | | | | | | | | 90 | 100 | 143 | 80 | 161,5 | 4 | 25 |
| CM02241 | SPC224 | 224 | 233,6 | 1 | 86 | 50 | 168 | 16 | 34,0 | 3 | 20 | | | | | | | | |
| CM02242 | | | | 2 | | | | | | | | | 88 | 60 | 168 | 18 | 59,5 | 3 | 20 |
| CM02243 | | | | 3 | | | | | | | | | 90 | 70 | 168 | 21 | 85,0 | 4 | 20 |
| CM02244 | | | | 4 | | | | | | | | | 90 | 90 | 168 | 50 | 110,5 | 4 | 25 |
| CM02245 | | | | 5 | | | | | | | | | 90 | 100 | 168 | 60 | 136,0 | 4 | 25 |
| CM02246 | | | | 6 | | | | | | | | | 90 | 100 | 168 | 60 | 161,5 | 4 | 25 |
| CM02501 | SPC250 | 250 | 259,6 | 1 | 86 | 50 | 193 | 16 | 34,0 | 3 | 20 | | | | | | | | |
| CM02502 | | | | 2 | | | | | | | | | 92 | 60 | 193 | 18 | 59,5 | 3 | 20 |
| CM02503 | | | | 3 | | | | | | | | | 92 | 70 | 193 | 21 | 85,0 | 4 | 20 |
| CM02504 | | | | 4 | | | | | | | | | 100 | 90 | 193 | 30 | 110,5 | 4 | 25 |
| CM02505 | | | | 5 | | | | | | | | | 102 | 100 | 193 | 50 | 136,0 | 4 | 25 |
| CM02506 | | | | 6 | | | | | | | | | 102 | 100 | 193 | 50 | 161,5 | 4 | 25 |
| CM02801 | SPC280 | 280 | 289,6 | 1 | 86 | 50 | 223 | 16 | 34,0 | 3 | 20 | | | | | | | | |
| CM02802 | | | | 2 | | | | | | | | | 92 | 60 | 223 | 18 | 59,5 | 3 | 20 |
| CM02803 | | | | 3 | | | | | | | | | 92 | 70 | 223 | 21 | 85,0 | 4 | 20 |
| CM02804 | | | | 4 | | | | | | | | | 100 | 90 | 223 | 25 | 110,5 | 4 | 25 |
| CM02805 | | | | 5 | | | | | | | | | 102 | 100 | 223 | 40 | 136,0 | 4 | 25 |
| CM02806 | | | | 6 | | | | | | | | | 102 | 100 | 223 | 40 | 161,5 | 4 | 25 |
| CM03001 | SPC300 | 300 | 309,6 | 1 | 86 | 50 | 243 | 16 | 34,0 | 3 | 20 | | | | | | | | |
| CM03002 | | | | 2 | | | | | | | | | 92 | 60 | 243 | 18 | 59,5 | 3 | 20 |
| CM03003 | | | | 3 | | | | | | | | | 92 | 70 | 243 | 21 | 85,0 | 4 | 20 |
| CM03004 | | | | 4 | | | | | | | | | 100 | 90 | 243 | 25 | 110,5 | 4 | 25 |
| CM03005 | | | | 5 | | | | | | | | | 104 | 100 | 243 | 25 | 136,0 | 4 | 25 |
| CM03006 | | | | 6 | | | | | | | | | 104 | 100 | 243 | 25 | 161,5 | 4 | 25 |

| Cod. interno Internal code Intern Code Code interne Código interno | Descrizione Description Beschreibung Description Descripción | P | O | Gole Grooves Rillen Gorges Canales | N | L | D | S | B | Forma Form Forme Forme Forma | d | Peso Weight Gewicht Poids Peso |
|--|--|------------|-------|--|-----|-----|-----|----|-------|--|----|--|
| CM03151 | SPC315 | 315 | 324,6 | 1 | 92 | 50 | 258 | 16 | 34,0 | 5 | 20 | |
| CM03152 | | | | 2 | 92 | 60 | 258 | 18 | 59,5 | 5 | 20 | |
| CM03153 | | | | 3 | 92 | 70 | 258 | 22 | 85,0 | 6 | 25 | |
| CM03154 | | | | 4 | 110 | 90 | 258 | 25 | 110,5 | 4 | 25 | |
| CM03155 | | | | 5 | 112 | 100 | 258 | 25 | 136,0 | 4 | 25 | |
| CM03156 | | | | 6 | 112 | 100 | 258 | 28 | 161,5 | 4 | 25 | |
| CM03351 | SPC335 | 335 | 344,6 | 1 | 100 | 50 | 283 | 16 | 34,0 | 5 | 20 | |
| CM03352 | | | | 2 | 100 | 60 | 283 | 18 | 59,5 | 5 | 20 | |
| CM03353 | | | | 3 | 100 | 70 | 283 | 22 | 85,0 | 6 | 25 | |
| CM03354 | | | | 4 | 114 | 90 | 283 | 25 | 110,5 | 6 | 25 | |
| CM03355 | | | | 5 | 114 | 100 | 283 | 28 | 136,0 | 6 | 25 | |
| CM03356 | | | | 6 | 114 | 100 | 283 | 30 | 161,5 | 6 | 25 | |
| CM03551 | SPC355 | 355 | 364,6 | 1 | 110 | 50 | 298 | 16 | 34,0 | 5 | 20 | |
| CM03552 | | | | 2 | 110 | 60 | 298 | 18 | 59,5 | 5 | 25 | |
| CM03553 | | | | 3 | 110 | 70 | 298 | 22 | 85,0 | 6 | 25 | |
| CM03554 | | | | 4 | 114 | 90 | 298 | 25 | 110,5 | 6 | 25 | |
| CM03555 | | | | 5 | 114 | 100 | 298 | 28 | 136,0 | 6 | 25 | |
| CM03556 | | | | 6 | 114 | 100 | 298 | 30 | 161,5 | 6 | 25 | |
| CM04001 | SPC400 | 400 | 409,6 | 1 | 110 | 60 | 343 | 18 | 34,0 | 5 | 25 | |
| CM04002 | | | | 2 | 110 | 70 | 343 | 20 | 59,5 | 5 | 25 | |
| CM04003 | | | | 3 | 114 | 90 | 343 | 24 | 85,0 | 5 | 25 | |
| CM04004 | | | | 4 | 114 | 90 | 343 | 26 | 110,5 | 6 | 25 | |
| CM04005 | | | | 5 | 120 | 100 | 343 | 28 | 136,0 | 6 | 25 | |
| CM04006 | | | | 6 | 120 | 100 | 343 | 30 | 161,5 | 6 | 25 | |
| CM04501 | SPC450 | 450 | 459,6 | 1 | 110 | 60 | 393 | 18 | 34,0 | 5 | 25 | |
| CM04502 | | | | 2 | 110 | 70 | 393 | 20 | 59,5 | 5 | 25 | |
| CM04503 | | | | 3 | 114 | 90 | 393 | 24 | 85,0 | 5 | 25 | |
| CM04504 | | | | 4 | 120 | 90 | 393 | 28 | 110,5 | 6 | 25 | |
| CM04505 | | | | 5 | 120 | 100 | 393 | 30 | 136,0 | 6 | 25 | |
| CM04506 | | | | 6 | 120 | 100 | 393 | 32 | 161,5 | 6 | 25 | |
| CM05001 | SPC500 | 500 | 509,6 | 1 | 114 | 60 | 443 | 18 | 34,0 | 5 | 25 | |
| CM05002 | | | | 2 | 114 | 70 | 443 | 20 | 59,5 | 5 | 25 | |
| CM05003 | | | | 3 | 114 | 90 | 443 | 24 | 85,0 | 5 | 25 | |
| CM05004 | | | | 4 | 126 | 90 | 443 | 28 | 110,5 | 6 | 25 | |
| CM05005 | | | | 5 | 126 | 100 | 443 | 30 | 136,0 | 6 | 25 | |
| CM05006 | | | | 6 | 126 | 100 | 443 | 32 | 161,5 | 6 | 25 | |
| CM05601 | SPC560 | 560 | 569,6 | 1 | 114 | 60 | 503 | 20 | 34,0 | 5 | 25 | |
| CM05602 | | | | 2 | 114 | 70 | 503 | 24 | 59,5 | 5 | 25 | |
| CM05603 | | | | 3 | 114 | 90 | 503 | 28 | 85,0 | 5 | 25 | |
| CM05604 | | | | 4 | 130 | 100 | 503 | 30 | 110,5 | 6 | 25 | |
| CM05605 | | | | 5 | 130 | 100 | 503 | 32 | 136,0 | 6 | 25 | |
| CM05606 | | | | 6 | 130 | 100 | 503 | 35 | 161,5 | 6 | 25 | |
| CM06001 | SPC600 | 600 | 609,6 | 1 | 114 | 60 | 543 | 20 | 34,0 | 5 | 25 | |
| CM06002 | | | | 2 | 114 | 70 | 543 | 24 | 59,5 | 5 | 25 | |
| CM06003 | | | | 3 | 114 | 90 | 543 | 28 | 85,0 | 5 | 25 | |
| CM06004 | | | | 4 | 130 | 90 | 543 | 30 | 110,5 | 6 | 25 | |
| CM06005 | | | | 5 | 130 | 100 | 543 | 32 | 136,0 | 6 | 25 | |
| CM06006 | | | | 6 | 130 | 100 | 543 | 35 | 161,5 | 6 | 25 | |
| CM06301 | SPC630 | 630 | 639,6 | 1 | 114 | 60 | 573 | 20 | 34,0 | 5 | 25 | |
| CM06302 | | | | 2 | 114 | 70 | 573 | 24 | 59,5 | 5 | 25 | |
| CM06303 | | | | 3 | 114 | 90 | 573 | 28 | 85,0 | 5 | 25 | |
| CM06304 | | | | 4 | 130 | 90 | 573 | 30 | 110,5 | 6 | 25 | |
| CM06305 | | | | 5 | 130 | 100 | 573 | 32 | 136,0 | 6 | 25 | |
| CM06306 | | | | 6 | 130 | 100 | 573 | 35 | 161,5 | 6 | 25 | |